

MICHIGAN AVE.

COMPUTER RAIL TRACKS

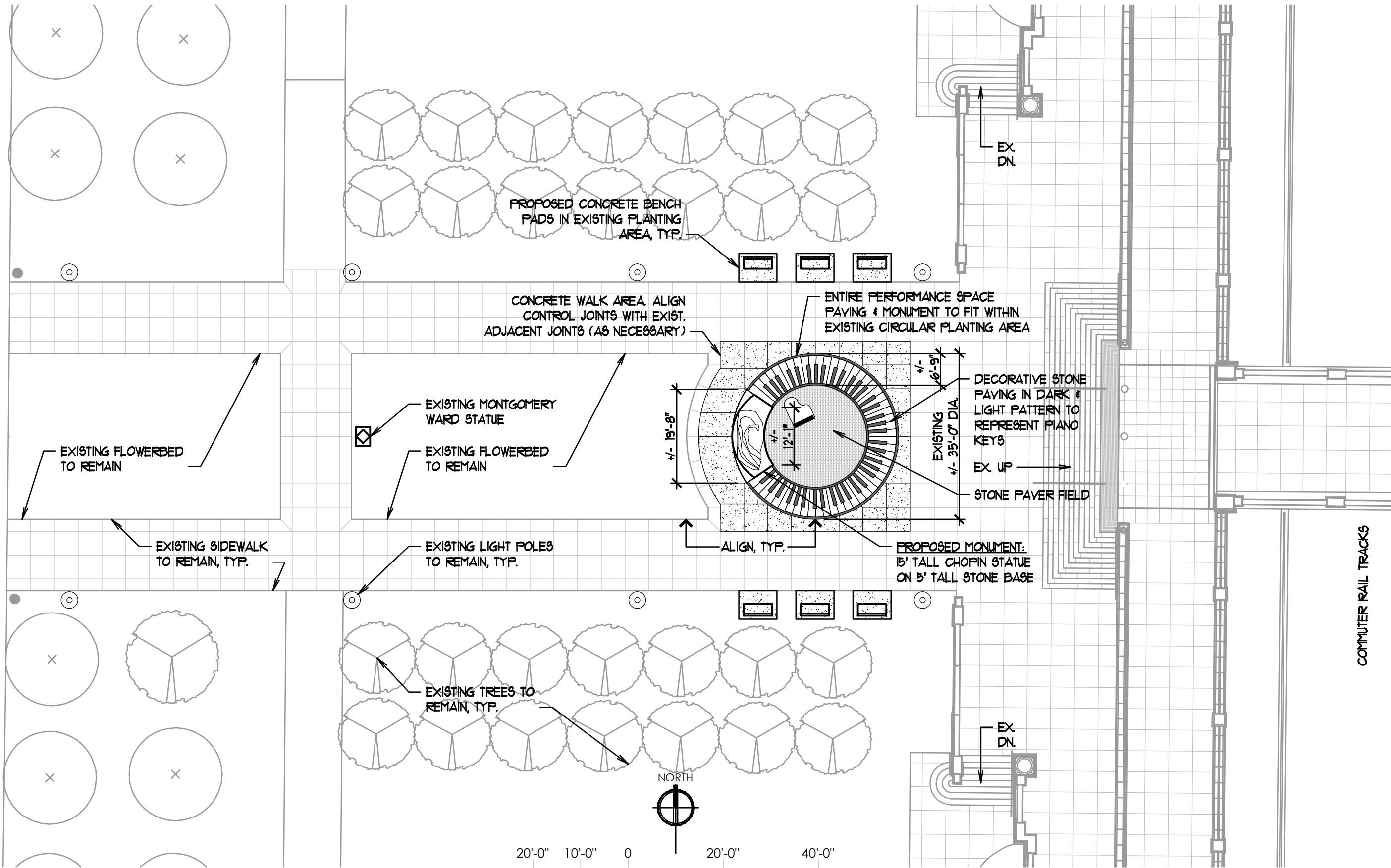

RIDGELAND ASSOCIATES INC.
 830 North Blvd.
 Oak Park
 Illinois 60301
 708.435.0300
 708.435.0305 fax
 www.ridgelandassociates.com

Chicago Chopin Monument

Proposed Site Plan

Drawing Date	8/5/11
Project Number	10048
Scale	1" = 20'-0"
<small>This document is an instrument of service and is the sole property of Ridgeland Associates, Inc. It may not be copied, reproduced, altered or reused in whole or in part on any other project without expressed written consent from Ridgeland Associates, Inc. ©2011 Ridgeland Associates, Inc.</small>	